

# TOTAL SAFETY SLOGGING WRENCHES



According to data published by the Ministry of Labor every year, **11% of all accidents are caused by tools in general (out of which 70% are caused by hand tools in particular).**

## THE MAIN CAUSES OF ACCIDENTS WHEN USING HAND TOOLS ARE:

- ▶ Cuts or blows to hand and fingers
- ▶ Eye injury caused by particles released either from the hand-tools or the objects being worked on
- ▶ Blows to different body parts due to flying tools or fallen hammer heads
- ▶ Impacts caused by tool drops

## 1- EGA MASTER HAS DEVELOPPED ANTIDROP AND ANTI-IMPACT SLOGGING WRENCHES THAT:

- ▶ To minimize such incidents, EGA MASTER has developed a new type of slogging wrench that eliminates hand and finger injuries and is safe to use when working at heights.
- ▶ The Total Safety Slogging Wrench includes a safety o-ring that wraps around the nut, increasing the friction and minimizing any looseness between the wrench and the nut. As a result, the wrench can be operated without the need of using any hand to hold it in place, therefore eliminating any probability of injury.
- ▶ In addition to the safety benefits, the wrench enables operational cost efficiencies to be achieved by reducing the number of people required to perform certain jobs (one person instead of two).

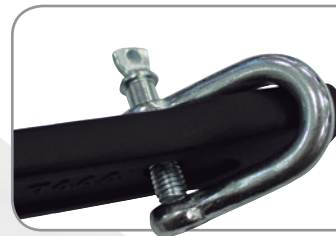

**2-** In addition to the o-ring, the wrench includes a removable shackle that allows the wrench to be secured through a safety lanyard, making it safe to be used at heights.

**3-** The o-ring is easily replaceable and supports temperatures up to 100°C. Replacements are available for each wrench.



**TOTAL SAFETY SLOGGING WRENCHES MM**

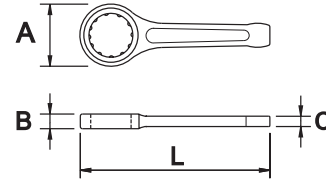

<b>COD</b>	<b>AF</b>	<b>L</b>	<b>A</b>	<b>B</b>	<b>C</b>	<b>Kg</b>	<b>5</b>	<b>1</b>	<b>⊙x5</b>	<b>⌒</b>
AD574257	22mm	155	38	13	8	0,2	5	1	89129	89021
AD574267	23mm	165	42	14	8,5				89130	89021
AD574277	24mm								89131	89021
AD574287	25mm	175	46	16	9,5	0,3			89132	89021
AD574297	26mm					89133			89021	
AD562957	27mm					89134			89021	
AD574307	28mm	185	50	16	0,4	89135			89021	
AD574317	29mm					89136			89021	
AD562967	30mm					89137			89021	
AD574327	31mm	210	55	18	0,5	89138			89021	
AD574337	32mm					89139	89021			
AD574347	33mm					89140	89021			
AD574357	34mm	220	60	19	0,6	89141	89021			
AD574367	35mm					89142	89021			
AD574377	36mm					89143	89021			
AD574387	37mm	225	20	12	0,7	89144	89022			
AD574397	38mm					89145	89022			
AD574407	41mm					89148	89022			
AD574417	42mm	240	75	22	13	89149	89022			
AD574427	45mm					89152	89022			
AD574437	46mm					89153	89022			
AD574447	47mm	250	80	23	1,2	89154	89022			
AD574457	48mm					89155	89022			
AD574467	50mm					89157	89022			
AD574477	52mm	270	85	24	1,4	89159	89022			
AD574487	54mm					89161	89022			
AD574497	55mm					89162	89022			
AD574507	56mm	300	90	26	1,6	89163	89022			
AD574517	58mm					89165	89022			
AD574527	59mm					89166	89022			
AD574537	60mm	320	110	32	1,7	89167	89022			
AD574547	61mm					89168	89022			
AD574557	62mm					89169	89022			
AD574567	63mm	320	110	32	1,7	89170	89022			
AD574577	64mm					89171	89022			
AD562977	65mm					89172	89022			
AD574587	66mm	330	115	33	1,8	89173	89023			
AD574597	67mm					89174	89023			
AD574607	68mm					89175	89023			
AD574617	69mm	320	110	32	1,7	89176	89023			
AD574627	70mm					89177	89023			
AD574047	71mm					89178	89023			
AD574057	72mm	320	110	32	1,7	89179	89023			
AD574067	73mm					89180	89023			
AD574077	74mm					89181	89023			
AD574087	75mm	330	115	33	18	2,9	89182	89023		

\* Not available in France

**TOTAL SAFETY SLOGGING WRENCHES INCH.**

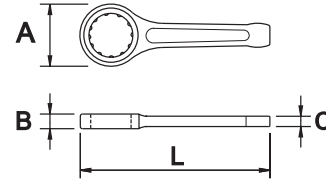

COD	AF	L	A	B	C	Kg	📦	📱	⊙x5	⤴
AD574657	7/8"	155	38	13	8	0,2	5	1	89187	89021
AD574667	15/16"	165	42	14	9				89188	89021
AD574677	1"	175	46	16	10	0,3			89189	89021
AD574687	1.1/16"								89190	89021
AD574697	1.1/8"	185	50		11	0,4			89191	89021
AD574707	1.3/16"								89192	89021
AD574717	1.1/4"	210	55	18	0,5	89193			89021	
AD574727	1.5/16"					89194			89021	
AD574737	1.3/8"	220	60	19	0,7	89195			89021	
AD574747	1.7/16"					89197			89022	
AD574757	1.1/2"	230	65	20	12	89198	89022			
AD574767	1.9/16"					89199	89022			
AD574777	1.5/8"	240	75	22	13	1	89200	89022		
AD574787	1.11/16"						89201	89022		
AD574797	1.3/4"	250	80	23	14	1,4	89202	89022		
AD574807	1.13/16"						89203	89022		
AD574817	1.7/8"	270	85	24	15	1,6	89204	89022		
AD574827	1.15/16"						89205	89022		
AD574837	2"	300	90	26	16	2,3	89206	89022		
AD574847	2.1/16"						89207	89022		
AD574857	2.1/8"	320	100	28	17	2,5	89208	89022		
AD574867	2.3/16"						89209	89022		
AD574877	2.1/4"	110	32	15	16	-	89210	89022		
AD574887	2.5/16"						89211	89022		
AD574897	2.3/8"	120	35	17	17	-	89212	89022		
AD574907	2.7/16"						89213	89022		
AD574917	2.1/2"	130	38	18	18	-	89214	89022		
AD574927	2.9/16"						89215	89022		
AD574937	2.5/8"	140	40	19	19	-	89216	89022		
AD574947	2.11/16"						89217	89023		
AD574957	2.3/4"	150	42	20	20	-	89218	89023		
		160	44	21	21	-	89219	89023		

\* Not available in France

# TECHNICAL SPECIFICATIONS

<b>MATERIAL</b>	Special steel	
<b>HARDNESS</b>	From 17mm (5/8") to 46mm (1.3/4")	34-40 HRC
	From 50mm (1.13/16") to 75mm (2.3/4")	30-36 HRC
<b>FINISHING</b>	Semi texturized black matt Epoxy powder	

**NON-SPARKING TOTAL SAFETY SLOGGING WRENCHES MM**

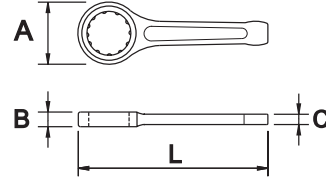

<b>COD</b>	<b>AF</b>	<b>L</b>	<b>A</b>	<b>B</b>	<b>C</b>	<b>Kg.</b>	<b>○x5</b>	<b>⤴</b>	
AD360987	22mm							89129	36191
AD360997	24mm	165	42	14	8,5	0,2		89131	36191
AD361007	25mm							89132	36191
AD361017	26mm	175	46	16	9,5	0,3		89133	36191
AD360747	27mm							89134	36191
AD361027	28mm							89135	36191
AD361037	29mm	185	53	19	10,5	0,4		89136	36191
AD360757	30mm							89137	36191
AD361047	31mm							89138	36191
AD360767	32mm							89139	36191
AD361057	33mm	200	58	19	11	0,5		89140	36191
AD361067	34mm							89141	36191
AD361077	35mm							89142	36191
AD360777	36mm							89143	36191
AD361087	37mm							89144	36192
AD361097	38mm	220	64	20	12	0,6		89145	36192
AD361107	39mm							89146	36192
AD361117	40mm							89147	36192
AD361127	41mm							89148	36192
AD361137	42mm							89149	36192
AD361147	43mm							89150	36192
AD361157	44mm	230	73	22	13	0,7		89151	36192
AD361167	45mm							89152	36192
AD361177	46mm							89153	36192
AD361187	47mm	240	78	23	13,5	0,8		89154	36192
AD361197	48mm							89155	36192
AD361207	49mm							89156	36192
AD361217	50mm							89157	36192
AD361227	51mm	250	86	23,5	14	0,9		89158	36192
AD361237	52mm							89159	36192
AD361247	53mm							89160	36192
AD361257	54mm							89161	36192
AD361267	55mm							89162	36192
AD361277	56mm	260	92	25,5	15	1,0		89163	36192
AD361287	57mm							89164	36192
AD361297	58mm							89165	36192
AD361307	59mm							89166	36192
AD361317	60mm							89167	36192
AD361327	61mm							89168	36192
AD361337	62mm	270	102	28	16	1,1		89169	36192
AD361347	63mm							89170	36192
AD361357	64mm							89171	36192
AD361367	65mm	300	108	31,5	17	1,2		89172	36192
AD361377	66mm							89173	36193
AD361387	67mm							89174	36193
AD361397	68mm							89175	36193
AD361407	69mm	320	113	33	18	1,3		89176	36193
AD361417	70mm							89177	36193
AD361427	71mm							89178	36193
AD361437	72mm							89179	36193
AD361447	73mm							89180	36193
AD361457	74mm	330	113	33	18	2,2		89181	36193
AD361467	75mm							89182	36193

\* Not available in France



**NON-SPARKING TOTAL SAFETY SLOGGING WRENCHES INCH.**

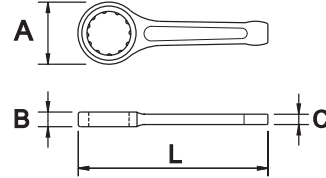

<b>COD</b>	<b>AF</b>	<b>L</b>	<b>A</b>	<b>B</b>	<b>C</b>	<b>Kg.</b>	<b>○x5</b>	<b>⌒</b>
AD361507	7/8"	165	42	14	8,5	0,4	89187	36191
AD361517	15/16"						89188	36191
AD361527	1"	175	46		9,5		89189	36191
AD361537	1-1/16"						89190	36191
AD361547	1-1/8"			16			89191	36191
AD361557	1-3/16"	185	53		10.5	0,5	89192	36191
AD361567	1-1/4"						89193	36191
AD361577	1-5/16"						89194	36191
AD361587	1-3/8"						89195	36191
AD361597	1-13/32"	200	58	19	11	0,6	89196	36192
AD361607	1-7/16"						89197	36192
AD361617	1-1/2"						89198	36192
AD361627	1-9/16"						89199	36192
AD361637	1-5/8"	220	64	20	12	0,7	89200	36192
AD361647	1-11/16"						89201	36192
AD361657	1-3/4"						89202	36192
AD361667	1-13/16"	230	73	22	13	0,8	89203	36192
AD361677	1-7/8"						89204	36192
AD361687	1-15/16"	250					89205	36192
AD361697	2"						89206	36192
AD361707	2-1/16"						89207	36192
AD361717	2-1/8"	260	78	23	13,5	1,3	89208	36192
AD361727	2-3/16"						89209	36192
AD361737	2-13/64"						89210	36192
AD361747	2-1/4"	270					89211	36192
AD361757	2-5/16"						89212	36192
AD361767	2-3/8"		92	25.5	15	1,4	89213	36192
AD361777	2-7/16"	280					89214	36192
AD361787	2-1/2"						89215	36192
AD361797	2-9/16"	300	102	30	16	1,4	89216	36192
AD361807	2-5/8"					1,5	89217	36193
AD361817	2-3/4"	320	108	31.5	17	2,3	89219	36193

\* Not available in France

## TECHNICAL SPECIFICATIONS

<b>MATERIAL</b>	Cu-Be
<b>HARDNESS</b>	283-365 Brinell

**CARABINER LANYARD WITH SWIVEL**

**RÍGID**

COD	L mm	UV RESISTANT	CAP	KG		KG	gr.	
66116	700	•	3 kg	3	5	35	125	1

UV resistant polyester and high resistance nylon and steel carabiners

Swivel system for easier use of the tool, avoiding the cord getting winded.



**LOOP LANYARD WITH SWIVEL**

**RÍGID**

COD	L mm	UV RESISTANT	CAP	KG		KG	gr.	
66117	630	•	3 kg	3	5	35	70	1

UV resistant polyester and high resistance nylon and steel carabiner

Swivel system for easier use of the tool, avoiding the cord getting winded.

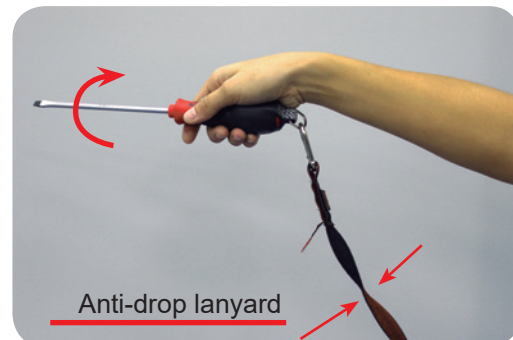
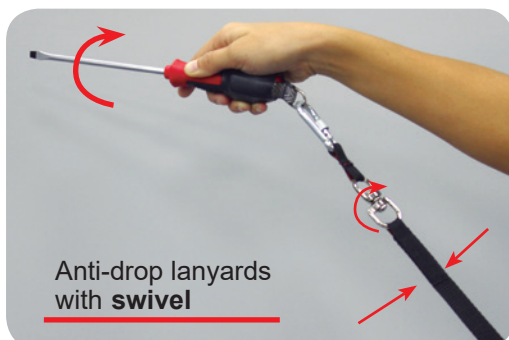

**CLIMBING ROPE CARABINER LANYARD**

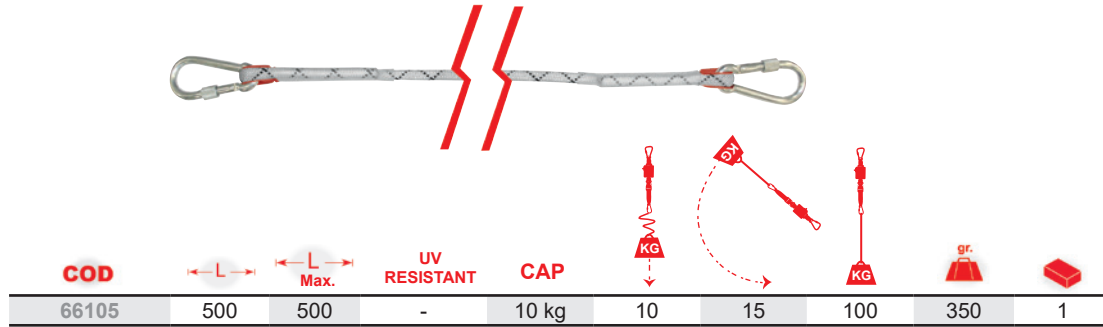

The Terylene® material (polyester fibre) is more resistant and has more capacity than Nylon, providing a safer heavy tool holding.